

Classrooms ~Steelcase LearnLab~

Imagine a classroom that improves the transfer of knowledge, dramatically enhances collaboration and engages multiple learning styles.

The LearnLab Environment actively supports the many ways that students learn today. The LearnLab grew out of a user-centered design process developed by Steelcase Workspace Futures group to fully understand the needs of today's students, faculty and improving the classroom experience. Key learnings from the research include the following: classrooms more than ever need to support multiple teaching and learning styles; the application of products and tools in the classroom is critical to how well students and teachers use them; better display of information is translated into better retention for students.





Classrooms ~Steelcase LearnLab~



Classrooms
 ~Typical LearnLab Layout~

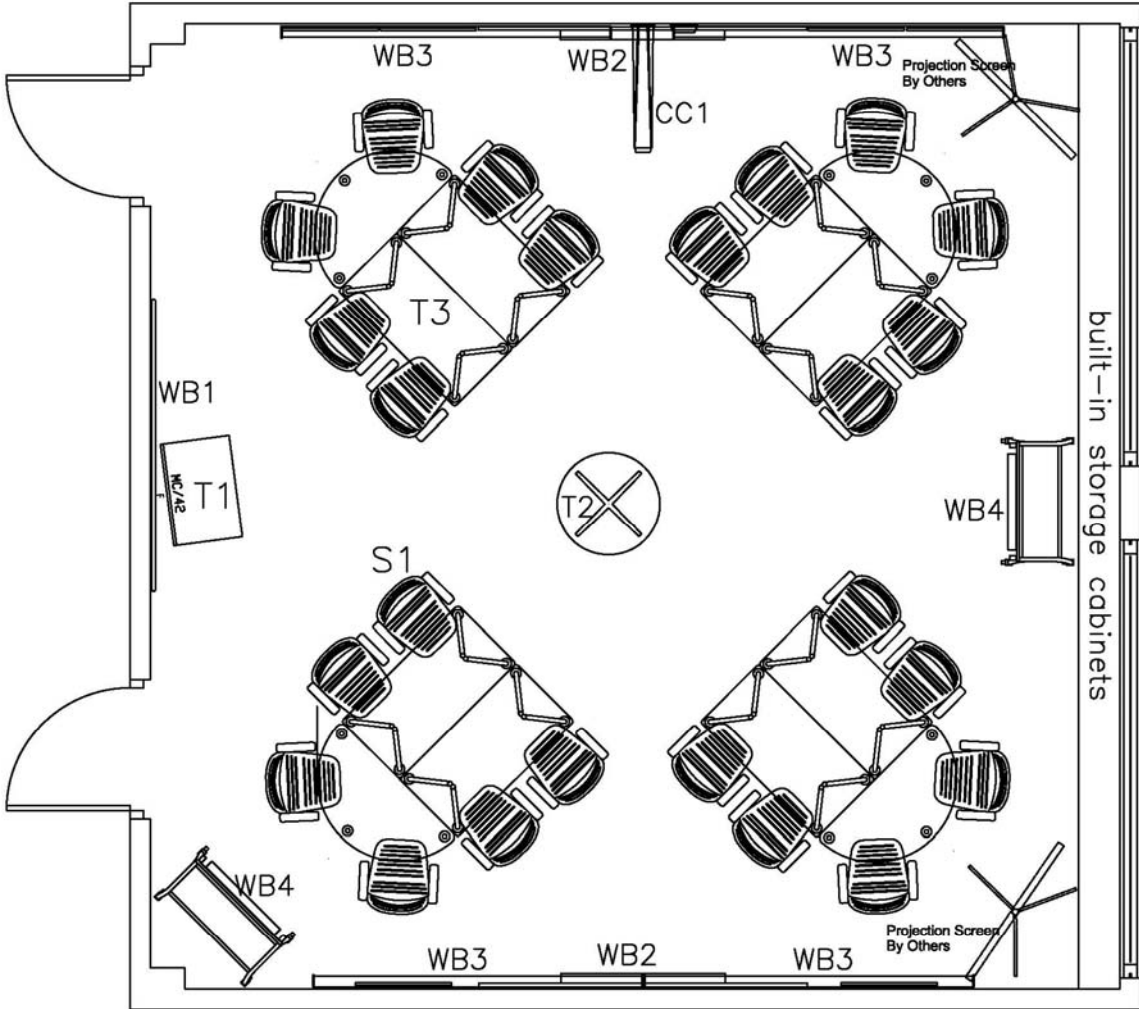

Note: Layouts will vary depending on classroom size



Classrooms ~Visual Worktools~



Item WB1: Steelcase Eno Interactive Whiteboard

Newberry College

Classrooms ~Visual Worktools~



Steelcase CopyCam (Item CC1) and Whiteboard (Item WB2) shown with Rail Track (Item WB3) and Huddleboard/Mobile Stand (Item WB4)

McWATERS
We make working easier.™

Classrooms
~Professor's Worktools~



Item T1: Turnstone Currency Mobile Cart



Item T2: Coalesse Mobile Round Table, 30"D (can be used for extra work space)

Classrooms ~Seating and Tables~



Item T3: Turnstone Groupwork Tables
(available with or without casters)



Item S1: Steelcase Cachet Chair
(arms can be flipped up
for an armless version)